

**AT Series**  
**ANALOG SIGNAL ISOLATED**  
**TRANSMITTER**

**USER'S MANUAL (V1.1)**

健昇科技股份有限公司

**JS AUTOMATION CORP.**

新北市汐止區中興路 100 號 6 樓

6F., No.100, Zhongxing Rd.,

Xizhi Dist., New Taipei City, Taiwan

TEL : +886-2-2647-6936

FAX : +886-2-2647-6940

<http://www.automation.com.tw>

<http://www.automation-js.com/>

E-mail : [control.cards@automation.com.tw](mailto:control.cards@automation.com.tw)

## Correction record

Version	Record
V1.1	Modify 6.Ordering information

# Contents

1. Features.....	3
2. Specifications.....	3
3. Calibration .....	4
4. Dimensions .....	4
5. Wiring Connection.....	5
6. Ordering information .....	6

## 1. Features

- Versatile Input selection : DC / AC / PT-100 / Potentiometer / Resistor / Load Cell
- Versatile output selection : 4~20mA , 0~20mA , 0~5V , 0~10V
- Accuracy :  $\pm 0.1\%$  F.S. (others) ;  $\pm 0.2\%$  F.S. (AC)
- Surge test of AC 2000V / 1min between input / output / power
- High stability, non-flammable case (PC), high safety

## 2. Specifications

- Input selection : DC / AC / PT-100 / Potentiometer / Resistor / Load Cell
- Output selection : 4~20mA , 0~20mA , 0~5V , 0~10V
- Accuracy :  $\pm 0.1\%$  F.S. (Others )  
 $\pm 0.2\%$  F.S. (AC)
- Zero Adjustment :  $\leq \pm 5\%$  F.S.
- Span Adjustment :  $\leq \pm 10\%$  F.S.
- Output Ripple :  $\leq \pm 0.1\%$  F.S.
- Temperature Coefficient : 100ppm/degree C(0~60 degree C )
- Output Response Time : < 250 msec (0~90%)
- Isolation : Input / Output / Power / Case
- Insulation Resistance : > 100M $\Omega$  with 500Vdc
- Surge Test : 2KVac/1min
- Input Impedence : Voltage: > 2V for 20K $\Omega$ /V;  $\leq 2V$  for > 200M $\Omega$   
Current:  $\geq 0.2A$  at 100mV; < 0.2A at 1V
- Output Capability : Voltage Output: < 20mA  
Current Output: < 10V
- Operating Temperature : 0-60 degree C
- Operating Humidity : 20 to 90% RH (non-condensing)
- Storage Temperature : -10-70 degree C
- Storage Humidity : 20 to 90% RH (non-condensing)
- Installation : Socket / Plug-in

### 3. Calibration

STEPS:

- Input the zero value and adjust the ZERO VR to the zero point.
- Input the span value and adjust the SPAN VR to the span point.

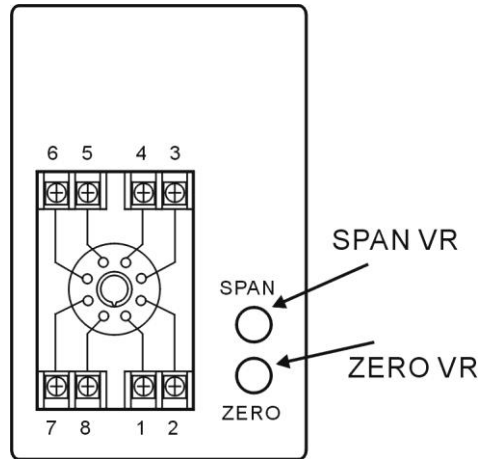

### 4. Dimensions

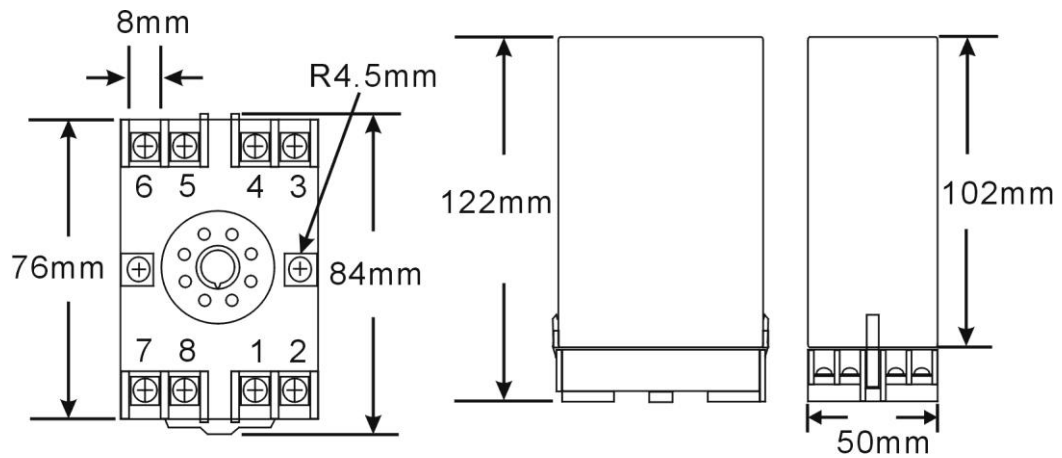

## 5. Wiring Connection

- Voltage (V), Current (A)(AC, DC)

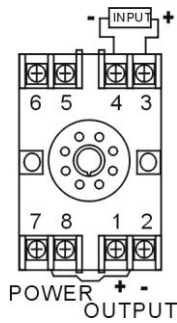

- 4 Wire Sensor or Load cell

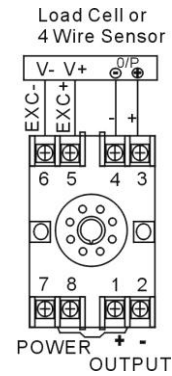

- Temperature (RTD)

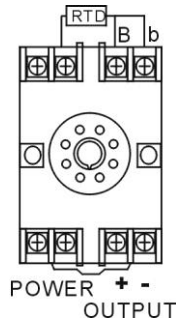

- 2 Wire Sensor

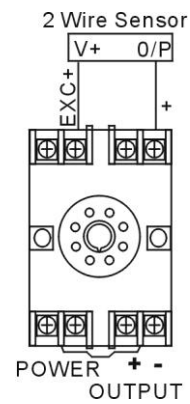

- 2 Wire Resistor

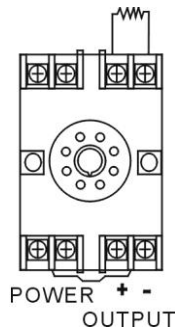

- 3 Wire Sensor

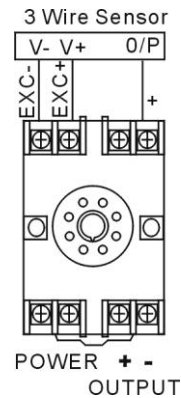

- 3 Wire Potentiometer

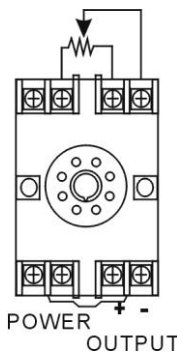

## 6. Ordering information

AT - Code 1 - Code 2 - Code 3 - Code 4

Code 1	Input Type	Code 2	Type	Range	Code 2	Load Cell	Code 3	Aux. Power	Code 4	Analog Output					
D	DC	V1	Voltage	0~50mV	L1	1mV/V EX.5V	A	AC/DC 100~240V	1	4~20mA					
		V2		0~5V	L2	2mV/V EX.5V			2	0~20mA					
		V3		1~5V	L3	3mV/V EX.5V			3	0~5V					
		V4		0~10V	L4	1mV/V EX.10V			4	0~10V					
		V5		0~36V	L5	2mV/V EX.10V			O	Option					
		V6		0~300V	L6	3mV/V EX.10V									
		V7		0~600V	LO	Option									
		VO		Option											
		A		AC AVG	A1	Current			0~20μA			D	AC/DC 24~60V		
					A2				0~200μA						
A3	0~2mA														
A4	0~20mA														
A5	0~200mA														
A6	4~20mA														
A7	0~2A														
A8	0~5A														
AO	Option														
P	3 Wire Potentiometer		P1		Potentiometer		500Ω~10KΩ								
		P2	10KΩ~100KΩ												
		P3	100KΩ~1MΩ												
		PO	Option												
I	2 Wire Resistor	I1	Resistor	0~10Ω											
		I2		0~100Ω											
		I3		0~1KΩ											
		I4		0~10KΩ											
		I5		0~100KΩ											
		IO		Option											
T	RTD (PT-100)	T1	RTD (PT-100)	-50~50℃											
		T2		0~50℃											
		T3		0~100℃											
		T4		0~200℃											
		T5		0~400℃											
		T6		0~600℃											
		TO		Option											
L	Load Cell														
2	2,3 Wire Sensor														
4	4 Wire Sensor														

- 1 : 2 wire type offers excitation power DC24V for 2 wire (Loop Power) pressure, temperature, humidity sensors using.
- 2 : 3.4 wire type offers excitation power DC24V for 3, 4 wire (Loop Power) pressure, temperature, humidity sensors using.
- 3 : Load Cell type of excitation power DC5V can have 2 load cell in parallel; DC10V only can offer 1 load cell to use.
- 4 : Please inquire salespersons for special type.